

PG CABLE GLANDS



Material

Body: PA 6 (Poyamide 6)
 Cap: PA 6 (Polamide 6)
 Seal: CR (Chloroprene Rubber)

Flammability

V2 (According to UL 94)

Protection Class

IP68 - 5 Bar (72.5 psi)

Operating Temperature

Permanent: -20°C to +100°C (-4°F to +212°F)
 Intermittent: -30°C to +150°C (-22°F to +302°F)

Thread

ANSI B 1.20.1

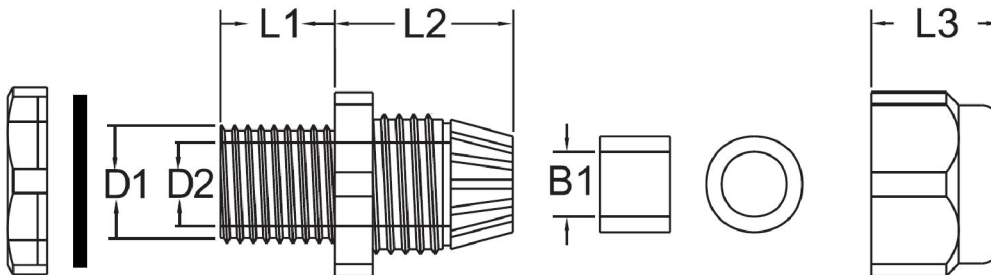

PG Gland Specs (mm)

	D1	D2	B1	L1	L2	L3	Cable Range	Units/Bag
PG-7	12.5	8.5	6.2	8.8	21.1	14.6	3.5-6	50
PG-9	15.6	11.0	8.8	8.6	22.9	14.9	4-8	50
PG-11	18.4	13.9	10.1	9.7	23.9	16.8	5-10	50
PG-13.5	20.4	15.6	12.0	9.5	25.2	17.7	6-12	50
PG-16	22.4	17.8	14.4	10.2	26.7	17.9	10-14	50
PG-21	28.1	22.2	18.1	11.2	30.3	22.6	13-18	50
PG-29	37.3	31.0	25.3	13.3	35.0	25.3	18-25	25
PG-36	47.1	39.4	31.9	14.8	42.2	29.8	22-32	10
PG-42	54.0	46.5	39.3	15.5	43.1	31.6	32-38	10
PG-48	59.2	49.4	44.8	15.4	42.9	32.6	37-44	10